

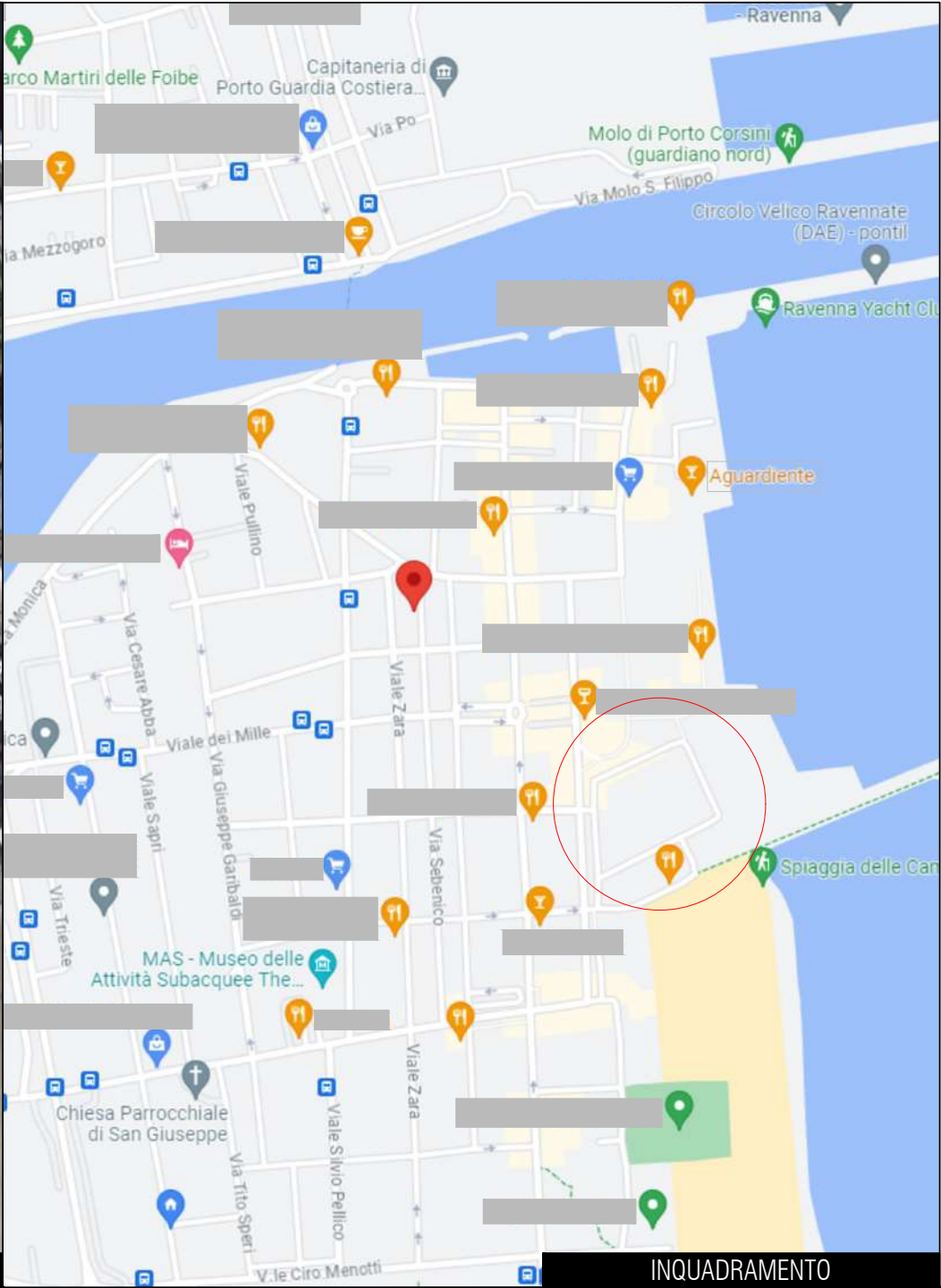

VISTA AEREA



INQUADRAMENTO



ESTRATTO DI MAPPA

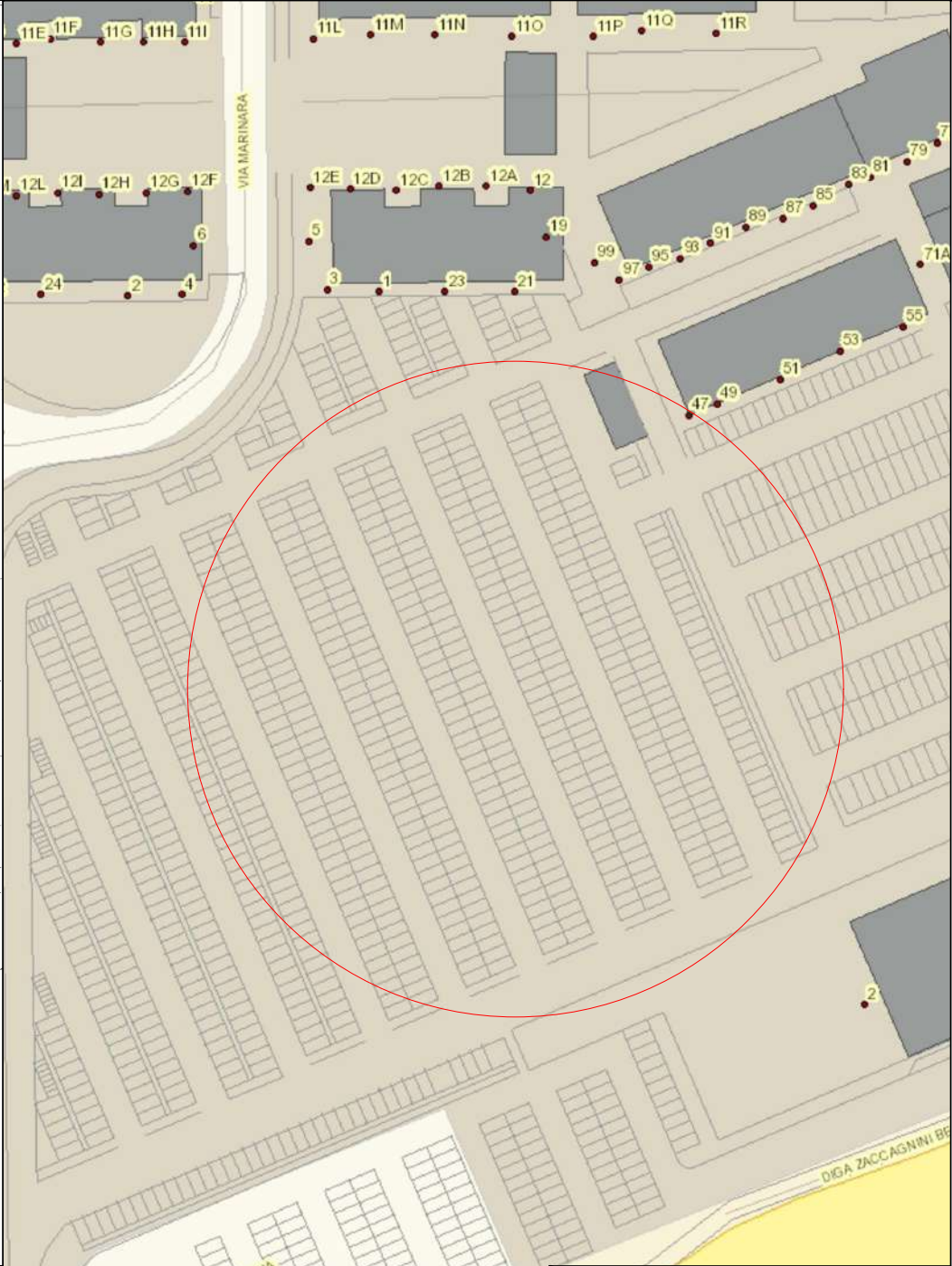

ESTRATTO SIT

ING. DAVIDE FUCHI VIA MONTE ADAMELLO, 14 48121 RAVENNA (RA)	TECNICO	COMMITTENTE	PROGETTO	ELABORATO	DATA	TAVOLA
	TRIBUNALE DI RAVENNA				24/04/2023	
ESECUZIONE IMMOBILIARE N. 52/2022 R.G.		INQUADRAMENTO PLANIMETRICO	SCALA			
			VARIE			

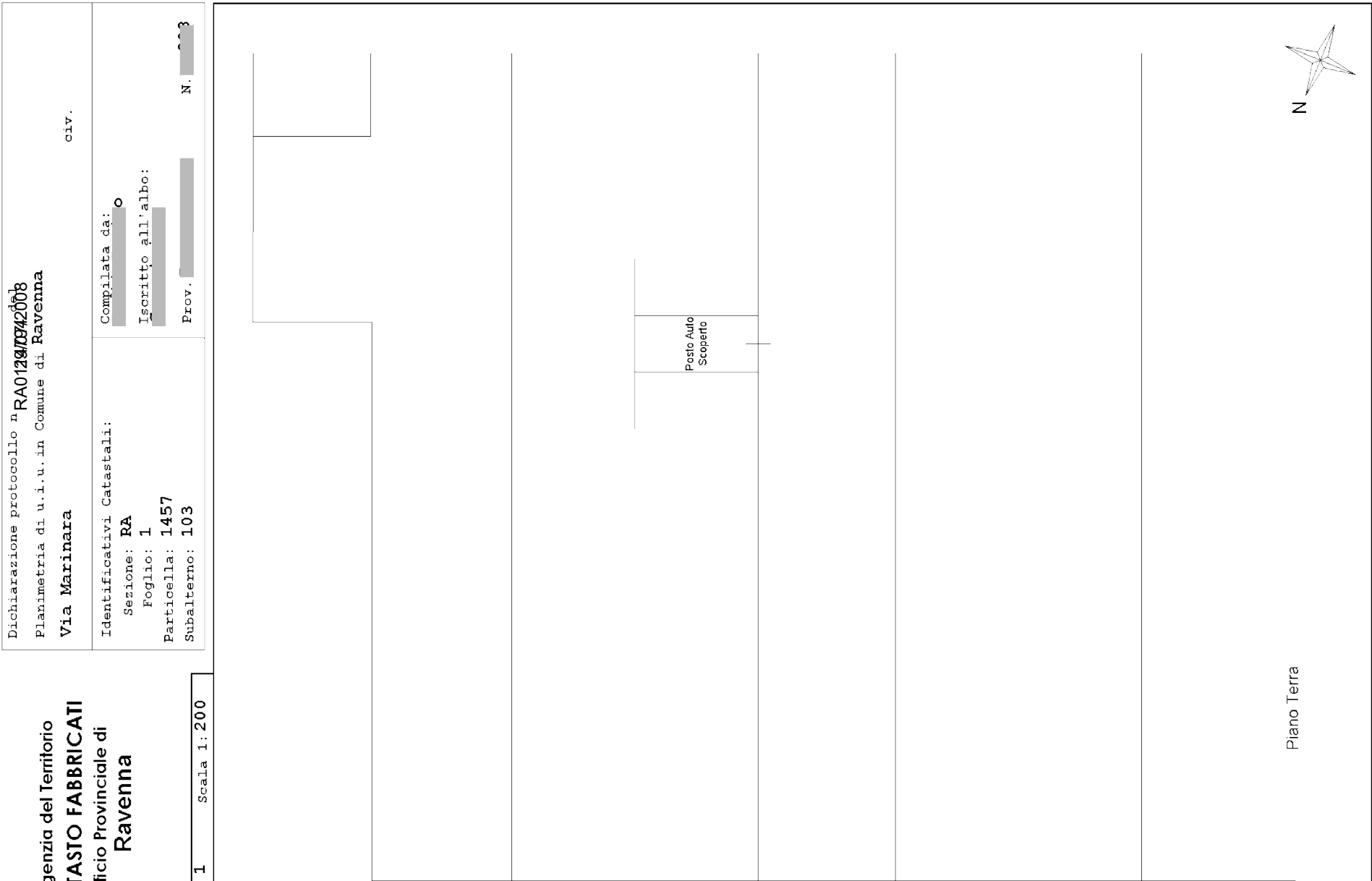
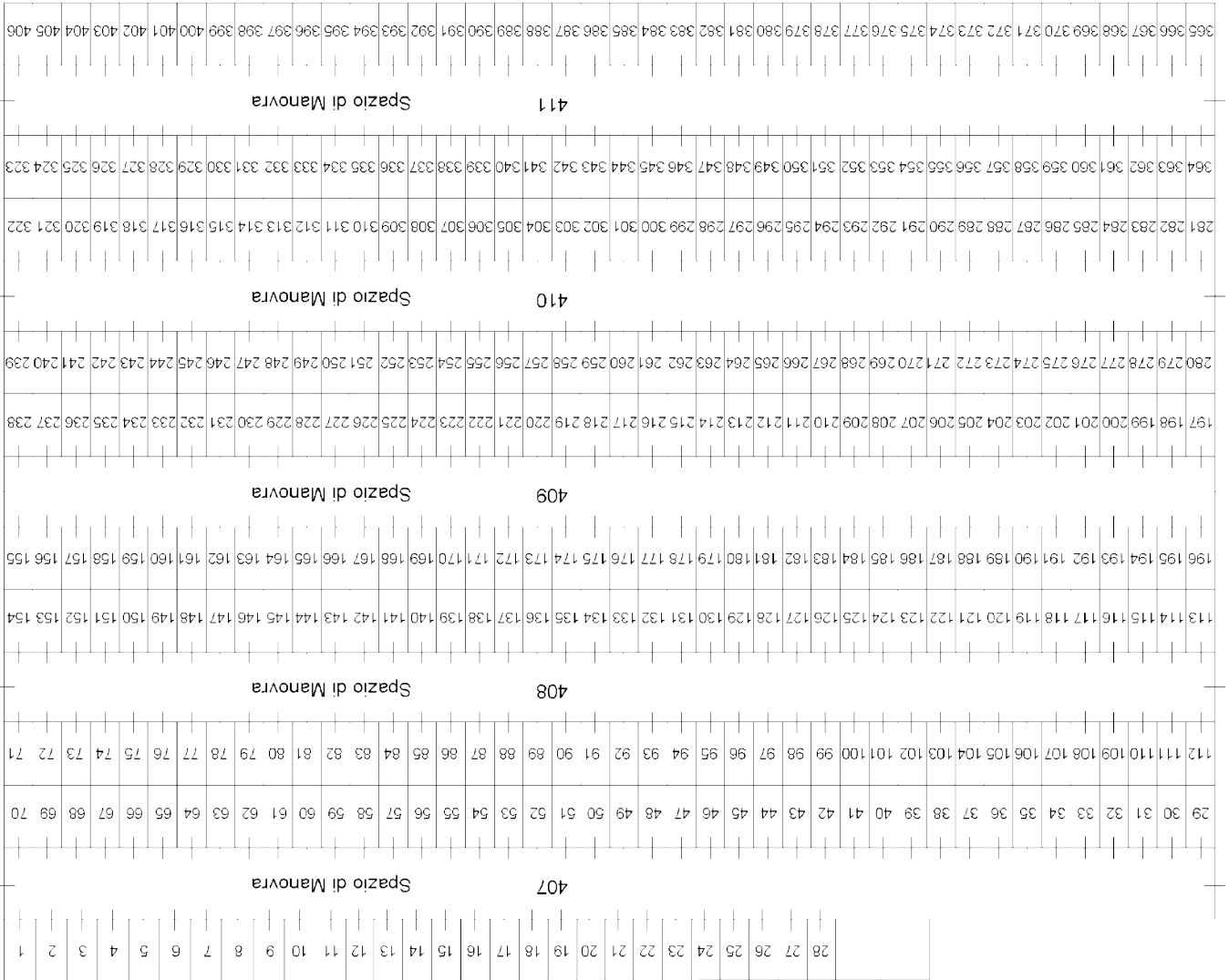

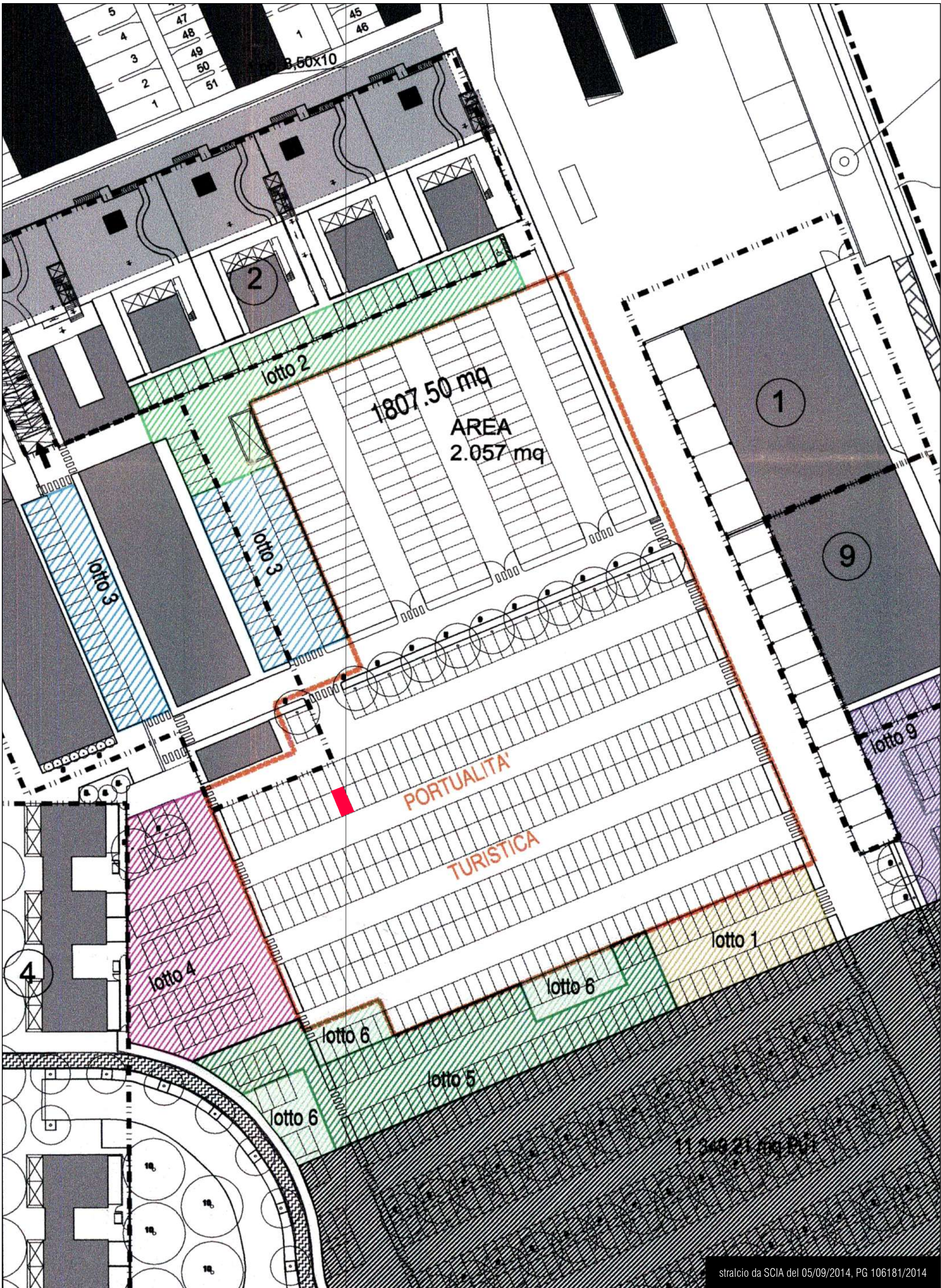

stralcio da SCIA del 05/09/2014, PG 106181/2014

<p>ING. DAVIDE FUCHI VIA MONTE ADAMELLO, 14 48121 RAVENNA (RA)</p>	<p>TRIBUNALE DI RAVENNA</p>	<p>ESECUZIONE IMMOBILIARE N. 52/2022 R.G.</p>	<p>PLANIMETRIA (pratica edilizia)</p>	<p>24/04/2023 fuori scala</p>	<p>5.3</p>
--	-----------------------------	---	---	-----------------------------------	------------

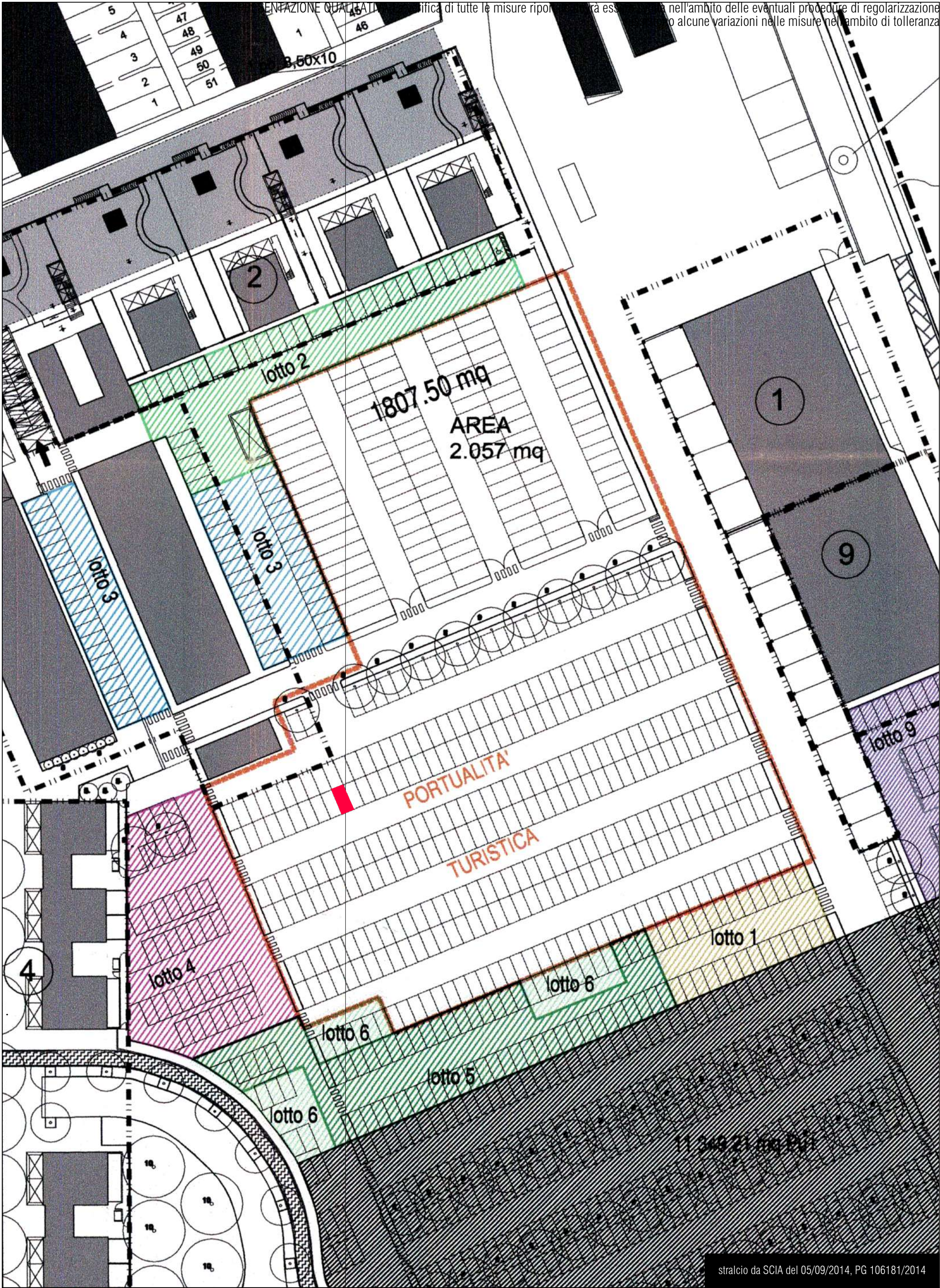

stralcio da SCIA del 05/09/2014, PG 106181/2014

<p>ING. DAVIDE FUCHI VIA MONTE ADAMELLO, 14 48121 RAVENNA (RA)</p>	<p>TRIBUNALE DI RAVENNA</p>	<p>ESECUZIONE IMMOBILIARE N. 52/2022 R.G.</p>	<p>PLANIMETRIA (rappresentazione stato dei luoghi)</p>	<p>24/04/2023 fuori scala</p>	<p>5.4</p>
--	-----------------------------	---	--	-----------------------------------	------------